

PART 1

STEGO WRAP VAPOR BARRIER/RETARDER INSTALLATION INSTRUCTIONS



IMPORTANT: Please read these installation instructions completely, prior to beginning any Stego Wrap installation to ensure suitable use of the product. The following installation instructions are based on ASTM E 1643 - Standard Practice for Installation of Water Vapor Retarders Used in Contact with Earth or Granular Fill under Concrete Slabs.

FIGURE 1: UNDER-SLAB INSTALLATION

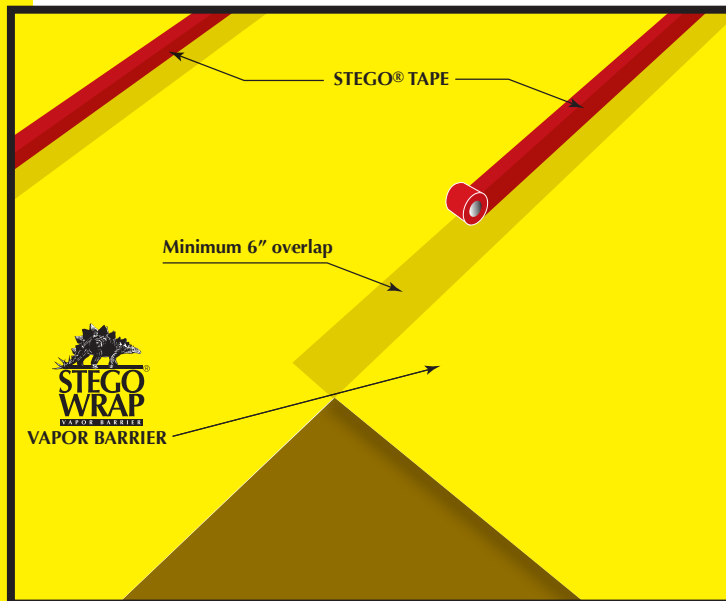

UNDER-SLAB INSTRUCTIONS:

1. Stego Wrap can be installed over an aggregate, sand, or tamped earth base. It is not necessary to have a cushion layer or sand base, as Stego Wrap is tough enough to withstand rugged construction environments.
2. Unroll Stego Wrap over the area where the slab is to be placed. Stego Wrap should completely cover the concrete placement area. All joints/seams both lateral and butt should be overlapped six inches and taped using Stego Tape.

NOTE: The area of adhesion should be free from dust, dirt and moisture to allow maximum adhesion of the pressure sensitive tape.

3. The most effective installation method includes positioning Stego Wrap on top of the footing and against the vertical wall. Stego Wrap will then be sandwiched between the footing, vertical wall and placed concrete floor (see part 2, figure 6a, Basement/Below Grade Wall Installation). This method will help protect the concrete slab from external moisture sources after the slab has been placed.

4. In the event that Stego Wrap is damaged during or after installation, repairs must be made. Stego Tape can be used to repair small holes in the material. For larger holes, cut a piece of Stego Wrap to a size and shape that covers any damage by a minimum overlap of six inches in all directions. Clean all adhesion areas of dust, dirt and moisture. Tape down all edges using Stego Tape (see figure 2, Sealing Damaged Areas).

FIGURE 2: SEALING DAMAGED AREAS

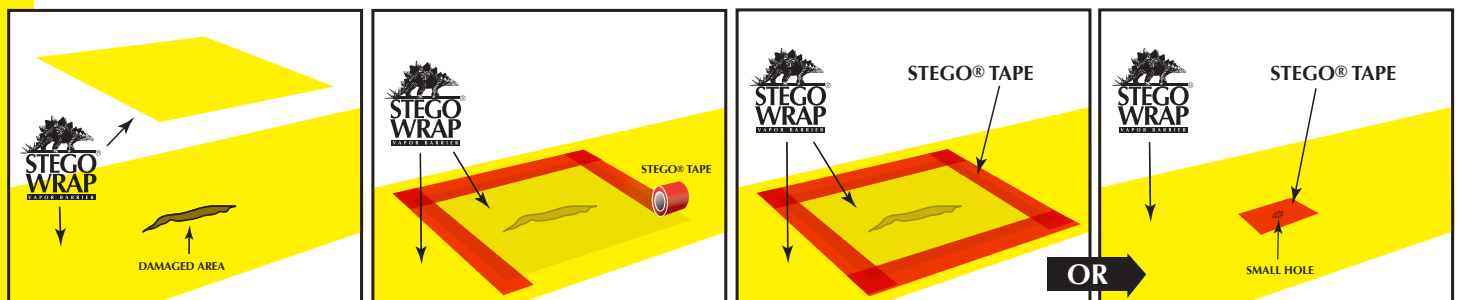

NOTE: These installation instructions are based on practices outlined in ASTM E 1643 - Standard Practice for Installation of Water Vapor Retarders Used in Contact with Earth or Granular Fill Under Concrete Slabs. These instructions are meant to be used as a guide, and do not take into account specific job site situations. Consult local building codes and regulations along with the building owner or owner's representative before proceeding. If you have any questions regarding the above mentioned installation instructions, Stego products, or a specific job site situation, please call us at 877-464-7834 for technical assistance.

- IMPORTANT: ALL PENETRATIONS MUST BE SEALED.** All pipe, ducting, rebar, wire penetrations and block outs should be sealed using Stego Wrap, Stego Tape and/or Stego Mastic (see figure 3a, Pipe Penetration Sealing).

FIGURE 3a: PIPE PENETRATION SEALING

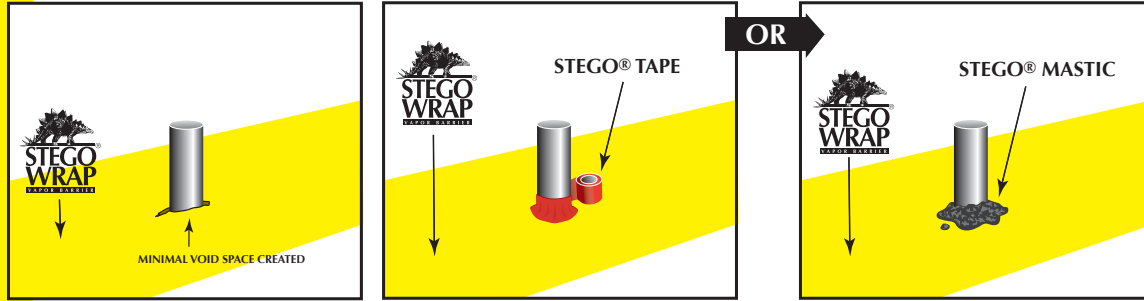

STEGO WRAP PIPE PENETRATION REPAIR DETAIL:

- 1: Install Stego Wrap around pipe penetration by slitting/cutting material as needed. Try to minimize the void space created.
- 2: If Stego Wrap is close to pipe and void space is minimized then seal around pipe penetration with Stego Tape and/or Stego Mastic. (See Figure 3a)
- 3: If detail patch is needed to minimize void space around penetration, then cut a detail patch to a size and shape that creates a six inch overlap on all edges around the void space at the base of the pipe. Stego Pre-Cut Pipe Boots are also available to speed up the installation.
- 4: Cut an "X" the size of the pipe diameter in the center of the pipe boot and slide tightly over pipe.
- 5: Tape down all sides of the pipe boot with Stego Tape.
- 6: Seal around the base of the pipe using Stego Tape and/or Stego Mastic. (See Figure 3b)

FIGURE 3b: DETAIL PATCH FOR PIPE PENETRATION SEALING

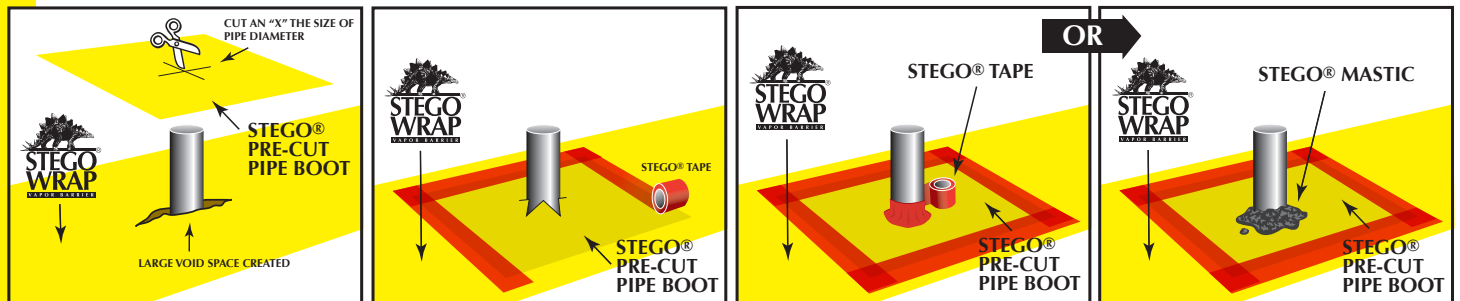

FIGURE 4: MULTIPLE PIPE PENETRATION SEALING



MULTIPLE PIPE PENETRATION SEALING:

Multiple pipe penetrations in close proximity and very small pipes may be sealed using Stego Wrap and Stego Mastic for ease of installation (see figure 4, Multiple Pipe Penetration Sealing).

6. Many vapor retarder manufacturers recommend a cushion layer (fine washed gravel or sand) on top of the retarder before the concrete placement to guard against the possibility of damage due to construction traffic. **This is permissible, but not a necessity with Stego Wrap.** Stego Wrap is strong enough to withstand normal construction traffic without a protective layer. In fact, ACI guidelines and many flooring companies recommend placement of the concrete slab directly on the vapor barrier/retarder. This eliminates the potential for water to be trapped in the blotter layer and ultimately resurfacing through the slab adversely affecting the flooring system.

NOTE: These instructions are meant to be used as a guide, and do not take into account specific job site situations. Consult local building codes and regulations along with the building owner or owner's representative before proceeding.

REMEMBER: If damaged, Stego Wrap must be repaired using the techniques outlined above.

PART 2

STEGO WRAP VAPOR BARRIER/RETARDER INSTALLATION INSTRUCTIONS



CRAWL SPACE INSTALLATION INSTRUCTIONS:

1. Place Stego Wrap directly over the crawl space floor. If rigid insulation is to be used, install Stego Wrap prior to insulation (under insulation and between the foundation wall and insulation).
2. Overlap seams a minimum of six inches and seal with Stego Tape.
3. Seal Stego Wrap around all penetrations and columns using Stego Tape and/or Stego Mastic.
4. Turn Stego Wrap up the foundation wall to a minimum height of six inches above the outside/exterior grade or in compliance with local building codes and terminate with pressure treated nail strip/termination bar or construction adhesive. If using a nail strip/termination bar, extend Stego Wrap above termination bar and fold back over nail strip/termination bar and tape with Stego Tape to seal nail holes.

FIGURE 5: CRAWL SPACE INSTALLATION

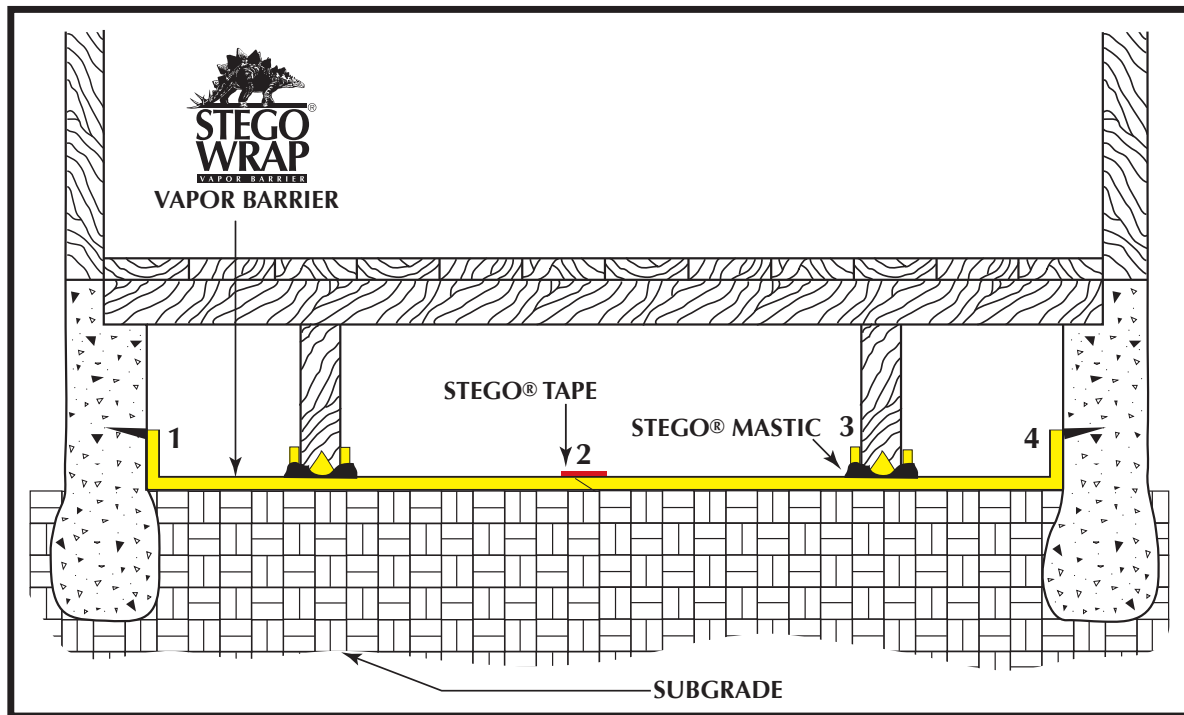

INSTALLATION TIPS:

1. For a cleaner look and to prevent against tenting of Stego Wrap at the foundation wall/foundation floor intersection, consider mechanically fastening Stego Wrap to base of foundation wall in addition to the above mentioned wall termination.
2. To provide additional protection against moisture migration through nail holes, consider applying a layer of Stego Mastic to the foundation wall prior to installing nail strip/termination bar. Allow one hour for Stego Mastic to cure prior to installing nail strip/termination bar.

NOTE: There are well-publicized pros and cons regarding different approaches to vapor barrier placement. Consult local building codes, regulations and ACI guidelines along with the design or architectural firm's recommendations before proceeding.

FIGURE 6a: BASEMENT/BELOW GRADE WALL INSTALLATION

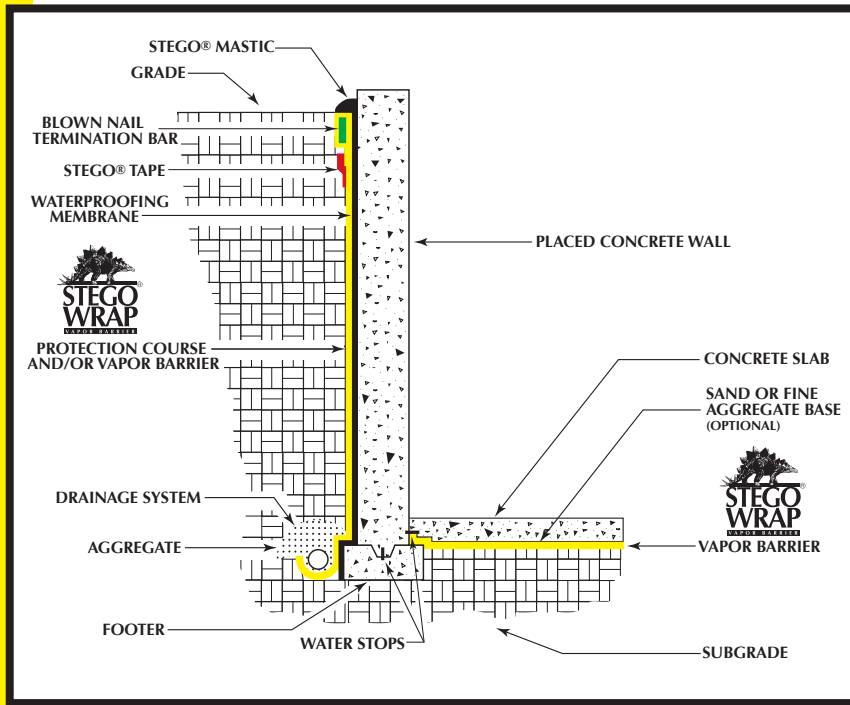

BASEMENT/BELOW GRADE WALL INSTALLATION:

1. Install an approved waterproofing membrane according to the manufacturer's installation instructions. This may include sheet goods, or liquid applied membranes be they roll, brush or spray.
2. While the membrane is still tacky, install Stego Wrap as a protective course/vapor barrier over the applied waterproofing membrane. Using a termination bar with concrete nails at the termination of the waterproofing membrane is advisable in some applications (see figure 6a, Basement/ Below Grade Wall Installation).
3. Supervised care must be taken during back filling against the material so that it is not damaged or punctured. If damage occurs, patch using the techniques outlined in part 1.

WARNING: Any untreated punctures, tears or damage during back filling will greatly reduce the effectiveness of Stego Wrap as a protection course/vapor barrier.

FIGURE 6b: OPTIONAL INSTALLATION FOR FOOTING ENCAPSULATION AND WATERPROOFING TIE-IN

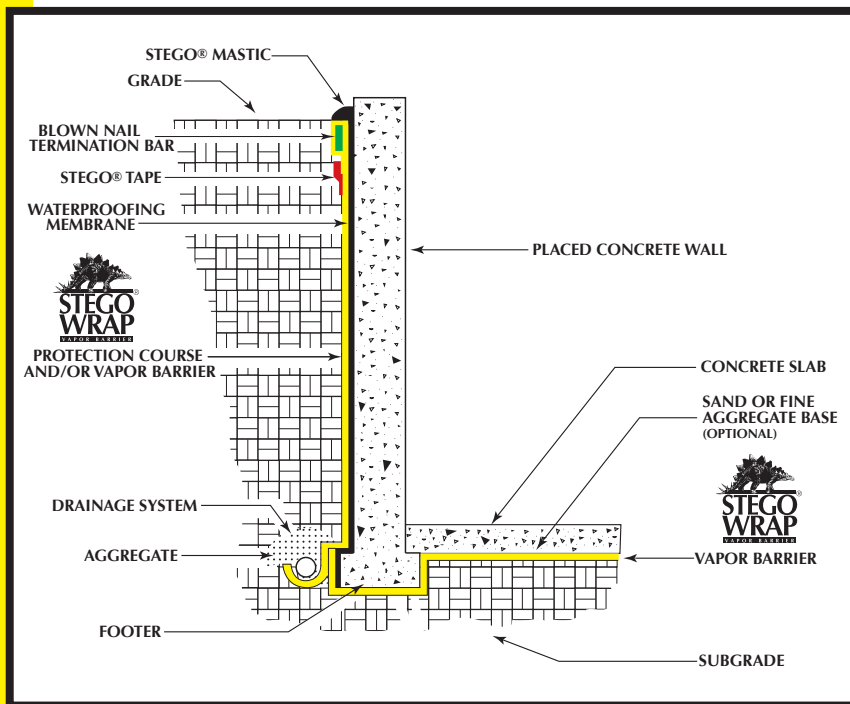

OPTIONAL INSTALLATION FOR FOOTING ENCAPSULATION AND WATER PROOFING TIE-IN:

1. Install Stego Wrap into footing depression prior to concrete placement.
2. Leave outside edge of footing exposed to allow for primary waterproofing application and tie-in (see figure 6b, Optional Installation For Footing Encapsulation and Waterproofing Tie-In).

NOTE: Consult Structural Engineer prior to footing encapsulation.

NOTE: These installation instructions are based on practices outlined in ASTM E 1643 - Standard Practice for Installation of Water Vapor Retarders Used in Contact with Earth or Granular Fill Under Concrete Slabs. These instructions are meant to be used as a guide, and do not take into account specific job site situations. Consult local building codes and regulations along with the building owner or owner's representative before proceeding. If you have any questions regarding the above mentioned installation instructions, Stego products, or a specific job site situation, please call us at 877-464-7834 for technical assistance.

